



## 2 Market Place

, Wallingford, OX10 0EG

**Guide price £170,000**



Situated in the town centre of Wallingford, a well presented, one bedroom apartment,



## Description

Situated in the town centre of Wallingford, a well presented one bedroom apartment,

Communal entry hall with storeroom leads to the top floor.

The front door opens to the reception hall leading to spacious open plan kitchen / living / dining room with built in appliances and Sash windows overlooking over the St Peters Church

Double bedroom with built in wardrobes Shower room with modern shower, WC and basin

Outside to Communal terrace with views over St Peters Church

Located within the town centre of Wallingford, with it's popular marketplace, local shops, cafés, bars, and restaurants, as well as Waitrose and Lidl.

Wallingford also offers easy access to the M4, M40, and A34, with Harwell Campus and mainline train stations at nearby Cholsey and Didcot.

## Area Map

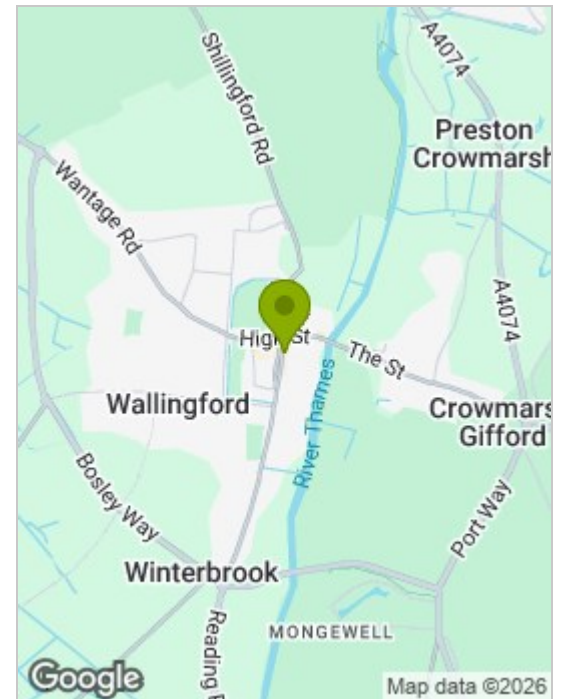

## Floor Plans

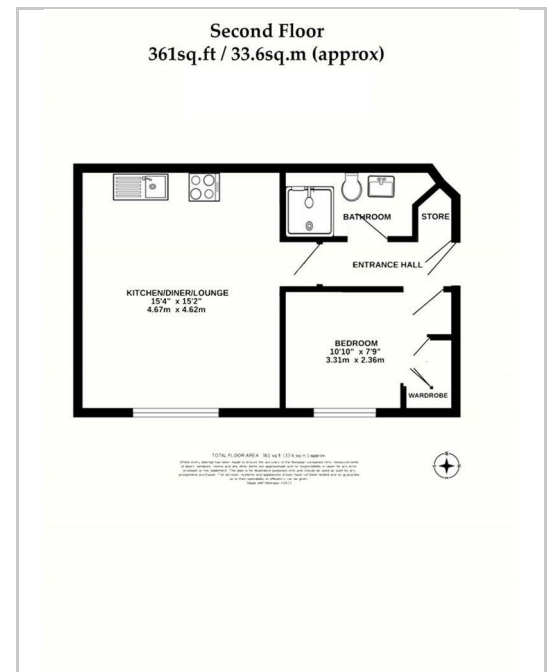

## Energy Efficiency Graph

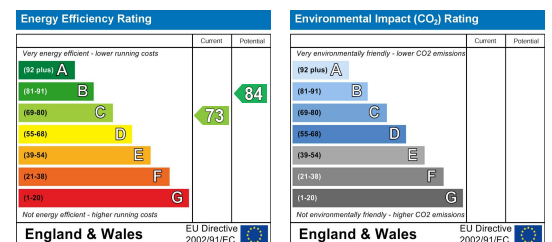

These particulars, whilst believed to be accurate are set out as a general outline only for guidance and do not constitute any part of an offer or contract. Intending purchasers should not rely on them as statements of representation of fact, but must satisfy themselves by inspection or otherwise as to their accuracy. No person in this firm's employment has the authority to make or give any representation or warranty in respect of the property.